

**FOREST COUNTY FORESTRY and RECREATION DEPARTMENT
200 EAST MADISON STREET
CRANDON, WI 54520
715-478-3475**

TO: PROSPECTIVE BIDDERS OF FOREST COUNTY TIMBER SALES

SUBJECT: 2022 TIMBER SALE OFFERINGS

BID DEADLINE: Monday, June 13, 2022

9:00 AM – Forestry Department Office Courthouse – Crandon, WI

FORESTRY MEETING: Wednesday, June 15, 2022

4:30 PM – County Board Room – Courthouse – Crandon, WI

Enclosed are timber sale maps of this year's sales, with a timber sale bid form listing the minimum bids for each timber sale. Forest County Lands are SFI & FSC 3rd Party Certified.

With each timber sale prospectus map, a bid form is included. Separate bid forms are necessary for each timber sale. Please compare the tract number at the top of each map with the tract number at the top of the timber sale bid form to be sure you are bidding on the correct timber sale. Your bid must meet or exceed the total timber sale value that was advertised. **For contractors interested in whole tree chipping please contact the Forestry Department at 715-478-3475 for formulas to calculate volumes. Bid bonds are not required.**

Please list the **tract number of the sale on your envelope** when submitting bids. All timber sale contracts will be three years in length. The Forestry and Recreation Committee may grant a one-year contract extension with a 10% stumpage price increase with prior approval. No contract will exceed four years in length. Failure to sign the timber sale contract will prohibit you from bidding on future timber sales. If you are the successful bidder, you will be required to pay a **performance bond of 25% of the total bid price, provide copies your FISTA training and liability/workman's compensation certificates prior to signing the timber sale contract.**

NOTICE: FISTA and Insurance certificates must be maintained through the duration of the contract. At least one person working on the sale must be FISTA Certified. Please note the payment method for each sale. Lump Sum sales require payment in full prior to starting the sale, or arrangements must be made with the seller to make block payments. Sales using the Mill Scale Ticket System will require the Purchaser to have load tickets sent directly from the receiving mill to the Seller within (25) days. Late load tickets will be invoiced by the Seller at 20 cords per load. *****Please note: Purchaser will have 15 days to pay stumpage invoices from date of billing (previous contracts allowed 30 days).**

****IMPORTANT**** To allow Forestry Department staff time to complete reference checks on timber sale bidders, all timber sale bids will be opened at 9:00am on Monday, June 13, 2022. The opening of bids will be held in the Forestry Department Office on the second floor of the Courthouse in Crandon. The bid opening will have County staff present, a Forestry and Recreation Committee member, a DNR representative and any member of the public wishing to attend the opening and recording of bids. No bids will be awarded at this time. All timber sale bids will be summarized and presented to the Forestry and Recreation Committee on Wednesday, June 15, 2022 at 4:30pm in the County Board Room of the Courthouse in Crandon. At this time, the Forestry and Recreation Committee will review and award timber sale contracts to successful bidders.

All Forest County timber sale maps, bid forms and bid results are also posted online by logging onto www.forestcountywi.com. Click on "2022 Timber Sale Bid Packet" or www.co.forest.wi.gov

Sincerely,

Travis Wollenberg

Travis Wollenberg
County Forest Administrator

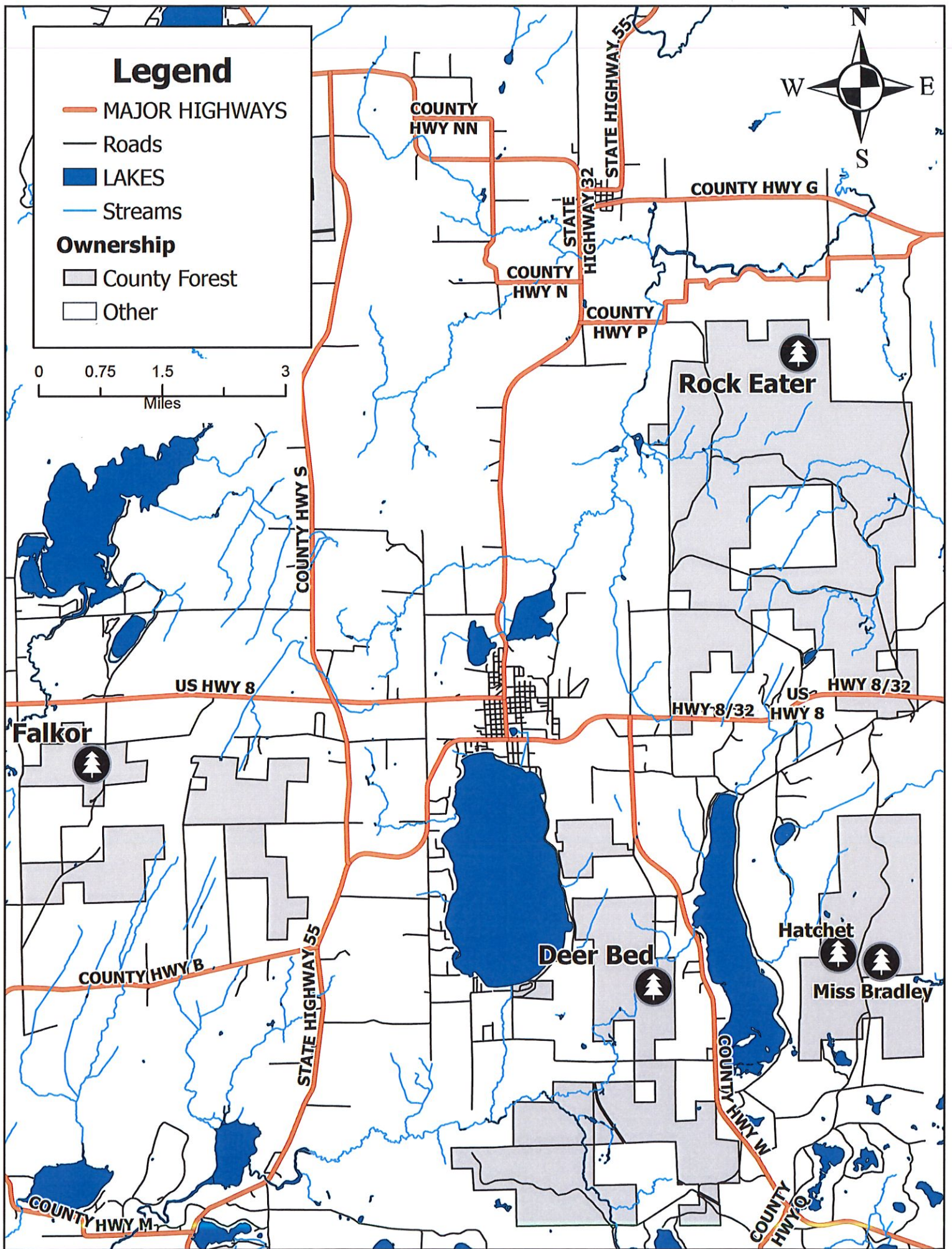

Forest County Forest
Deer Bed Timber Sale – Tract 1-22
Parts of SESE, Sec.9, NENE, NWNE, SWNE Sec. 16, T.35N. R.13E.
Sale area 51 acres
(Mapped by Jared Oemig 2/15/2022)

Harvest Specifications:

Block 1 – Aspen, 51 acres

- Cut all trees 2 inches and larger, **EXCEPT** red oak, yellow birch, spruce and trees marked with green paint.
- Cut all merchantable balsam with 2 sticks or more.

All Blocks

- No cutting, skidding or trucking will be allowed during spring break up or wet soil conditions.
- No tree length or pole skidding is allowed without prior approval.
- All wood will be sorted by species and categories as listed in table below.
- All species and products shall be cut concurrently.
- Reasonable care shall be used to avoid unnecessary damage to reserve trees.
- **Do not cut dead trees unless marked with orange paint or, if they pose a safety hazard.**
- No equipment use or slash disposal in wetlands.
- Any gates, rocks, berms or other barriers removed for access will be repaired or replaced.
- All slash and logging debris must be lopped to within 2 feet of the ground and pulled back 25 feet from road.

Sale Information:

- Pulp & Bolts - Mill Ticket
- Saw Logs – Field Scale
- Other Products – Determined by County
- Seasonal Restrictions:
 - March 15th- July 15th No Harvesting
- Completion Date: July 1, 2025
- Notify County in advance of starting
- Forestry Department: 715-478-3475

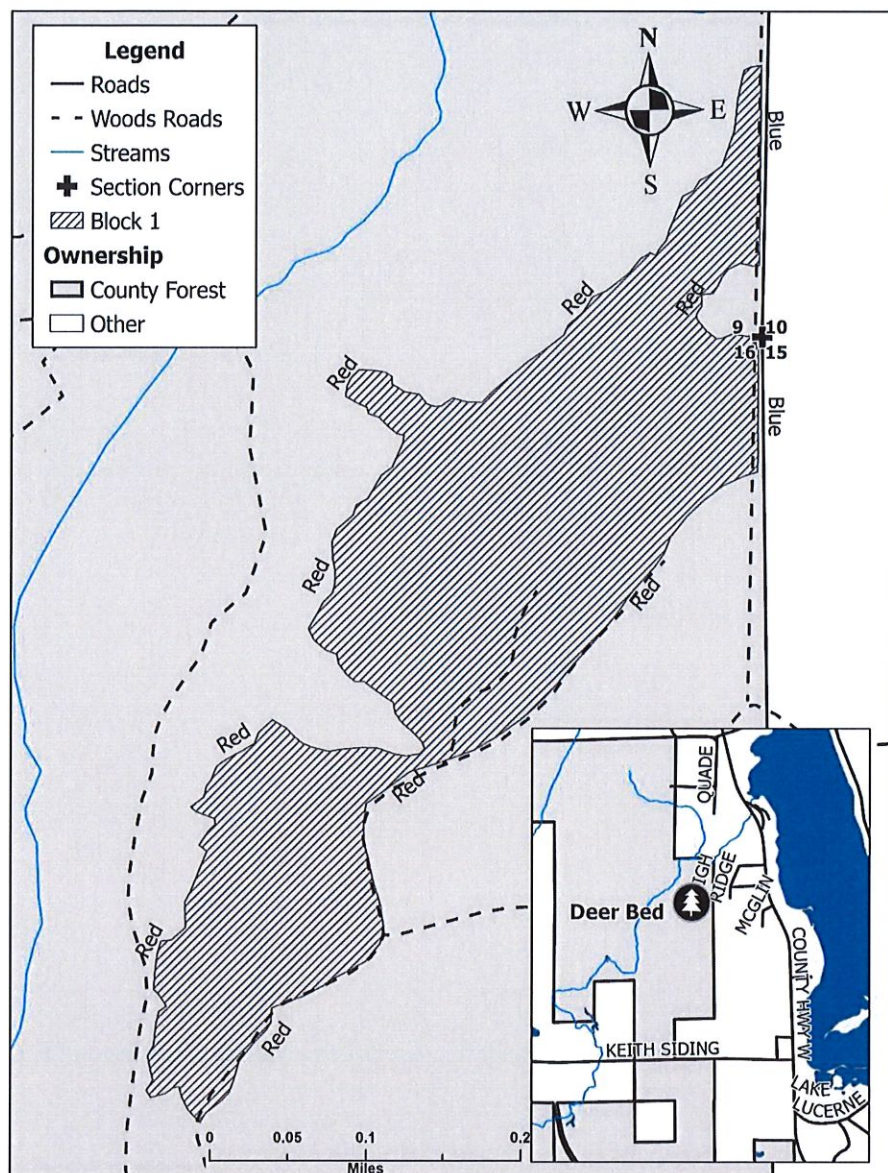

ESTIMATED VOLUME

Pulpwood / Bolts		Sawlogs	
Species	Tons (Cords)	Species	MBF
ASPEN	3150 (1400)	BASSWOOD	5
MIXED HARDWOODS	575 (240)	HARD MAPLE	4
BALSAM FIR	65 (30)	MIXED HARDWOODS	2
BASSWOOD	50 (25)		
Total	3840 (1695)	Total	11

Forest County Forestry & Recreation Department

Timber Sale Bid Sheet

Advertised species, products and value for sale tract#: **1-22** Approximate cutting area: **51** acres
 Township: **Lincoln**

Product Species		Estimated Unit Volume	Bid Per Unit	Total
20T-A	Aspen Pulp	3,150.00 Tons	_____	_____
20T-MX	Mixed Hdwd Pulp	575.00 Tons	_____	_____
20T-FB	Balsam Fir Pulp	65.00 Tons	_____	_____
20T-BA	Bass Wood Pulp	50.00 Tons	_____	_____
10-BA	Basswood Sawlogs	5.00 MBF	_____	_____
10-MH	Hard Maple Sawlogs	4.00 MBF	_____	_____
10-MX	Mixed Hardwood Sawlogs	2.00 MBF	_____	_____
		34,663.50		
		Minimum Total Bid		Total Bid

All products must have a bid price.

Bid bonds will be waived for 2022. If you are the successful bidder, you will be required to pay a performance bond of 25% of the total bid price at contract signing. You will also be required to provide copies of your SFI training and liability/workman's compensation certificates prior to signing the timber sale contract. At least one (1) person working on the sale must be SFI Certified. **Contracts will not be issued without the 25% performance bond, SFI training certificate and liability/workman's compensation certificate.**

NOTE: This bid, when properly filled out, should be placed in a plain envelope and sealed. Mark the envelope 'Sealed Bid - Timber Stumpage', indicate the Tract Number. Place this sealed envelope in a mailing envelope and mail to the Forest County Forestry & Recreation Department, 200 E. Madison St. Crandon, WI 54520. Bids may be hand delivered in a sealed envelope to the office. Check bid notice for deadline date and time. For more information, please call 715-478-3475. See timber Bid Conditions on the timber sale prospectus.

The Seller has the right to reject any and all bids. Volumes are estimates. All bidders are encouraged to examine sale to verify volumes and quality of all timber. Bidders should be prepared to submit a performance bond and references upon request.

Name _____

Address _____

City, State, Zip _____

Phone #: _____

Bidder Signature _____

Date _____

Forest County Forest
Falkor Timber Sale – Tract 2-22
Parts of NE ¼, Parts of NW ¼ SE ¼, Sec. 32, T.36 N., R.12 E.
Sale area 78 acres
(Mapped by Travis Wollenberg 2/4/22)

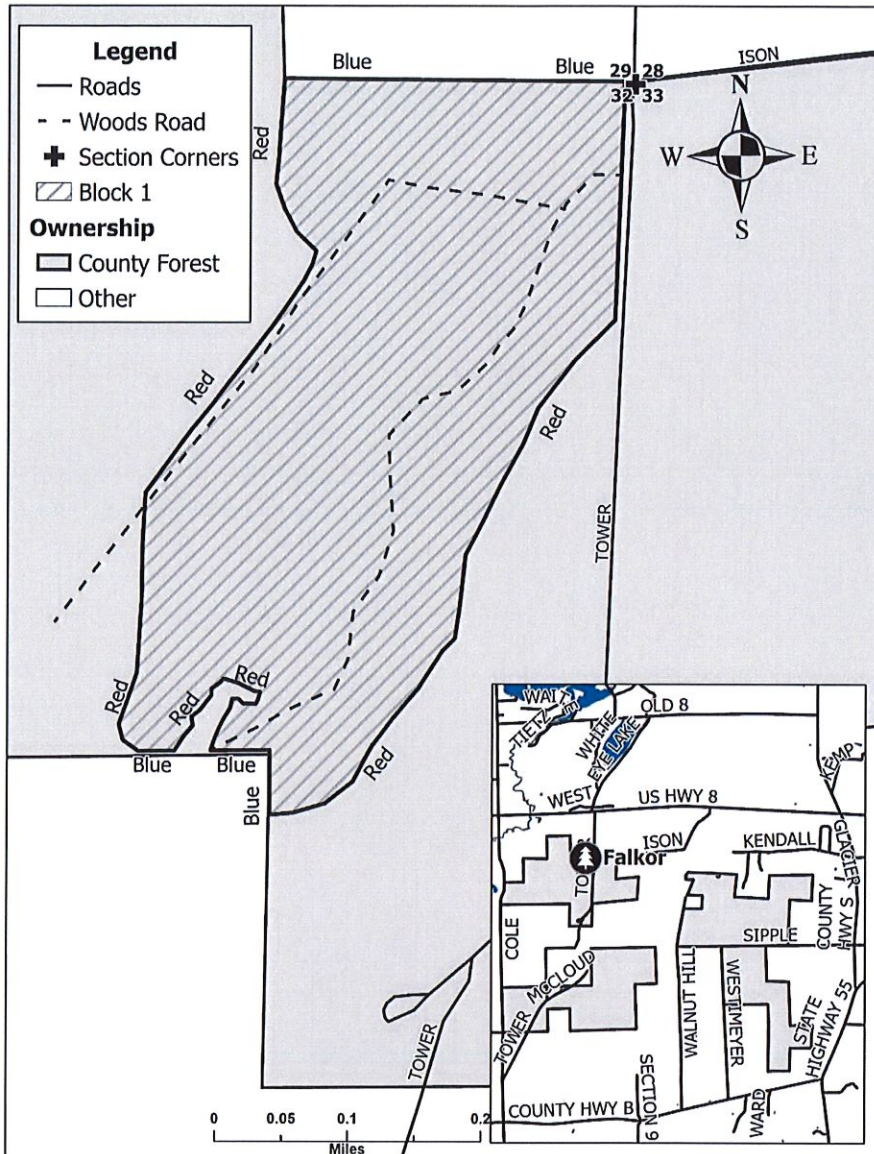

Harvest Specifications:
Block 1 – Northern Hardwood, 78 acres
 • Cut all trees marked with orange paint. In addition, harvest all merchantable aspen, balsam fir, white birch and ironwood.

- All Blocks**
- No cutting, skidding or trucking will be allowed during spring break up or wet soil conditions.
 - No tree length or pole skidding is allowed without prior approval.
 - All wood will be sorted by species and categories as listed in table below.
 - All species and products shall be cut concurrently.
 - Reasonable care shall be used to avoid unnecessary damage to reserve trees.
 - **Do not cut dead trees unless marked with orange paint or, if they pose a safety hazard.**
 - No equipment use or slash disposal in wetlands.
 - Any gates, rocks, berms or other barriers removed for access will be repaired or replaced.
 - All slash and logging debris must be lopped to within 2 feet of the ground and pulled back 25 feet from roads.

- Sale Information:**
- Pulp & Bolts - Mill Ticket
 - Saw Logs – Field Scale
 - Other Products – Determined by County
 - Seasonal Restrictions:
 - March 15th - July 15th No Harvesting
 - Completion Date: July 1, 2025
 - Notify County in advance of starting
 - Forestry Department: 715-478-3475

ESTIMATED VOLUME

Pulpwood / Bolts		Sawlogs	
Species	Tons (Cords)	Species	MBF
MIXED HARDWOOD	875 (360)	BASSWOOD	55
BASSWOOD	800 (410)	MIXED HARDWOOD	25
ASPEN	75 (35)	HARD MAPLE	15
BALSAM FIR	35 (15)		
Total	1785 (820)	Total	95

Forest County Forestry & Recreation Department

Timber Sale Bid Sheet

Advertised species, products and value for sale tract#: **2-22** Approximate cutting area: **78** acres
 Township: **Crandon**

Product Species	Estimated Unit Volume	Bid Per Unit	Total
20T-MX Mixed Hdwd Pulp	875.00 Tons		
20T-BA Bass Wood Pulp	800.00 Tons		
20T-A Aspen Pulp	75.00 Tons		
20T-FB Balsam Fir Pulp	35.00 Tons		
10-BA Basswood Sawlogs	55.00 MBF		
10-MX Mixed Hardwood Sawlogs	25.00 MBF		
10-MH Hard Maple Sawlogs	15.00 MBF		
	22,704.00		
	Minimum Total Bid		Total Bid

All products must have a bid price.

Bid bonds will be waived for 2022. If you are the successful bidder, you will be required to pay a performance bond of 25% of the total bid price at contract signing. You will also be required to provide copies of your SFI training and liability/workman's compensation certificates prior to signing the timber sale contract. At least one (1) person working on the sale must be SFI Certified. **Contracts will not be issued without the 25% performance bond, SFI training certificate and liability/workman's compensation certificate.**

NOTE: This bid, when properly filled out, should be placed in a plain envelope and sealed. Mark the envelope 'Sealed Bid - Timber Stumpage', indicate the Tract Number. Place this sealed envelope in a mailing envelope and mail to the Forest County Forestry & Recreation Department, 200 E. Madison St. Crandon, WI 54520. Bids may be hand delivered in a sealed envelope to the office. Check bid notice for deadline date and time. For more information, please call 715-478-3475. See timber Bid Conditions on the timber sale prospectus.

The Seller has the right to reject any and all bids. Volumes are estimates. All bidders are encouraged to examine sale to verify volumes and quality of all timber. Bidders should be prepared to submit a performance bond and references upon request.

Name _____

Address _____

City, State, Zip _____

Phone #: _____

Bidder Signature _____

Date _____

Forest County Forest
Rock Eater Timber Sale – Tract 3-22
Parts of SENW, NESW, NWSE, SWNE and NESE, SENE Sec. 2, T.36N. R.13E.
Sale area 75 acres
(Mapped by Jared Oemig 2/21/22)

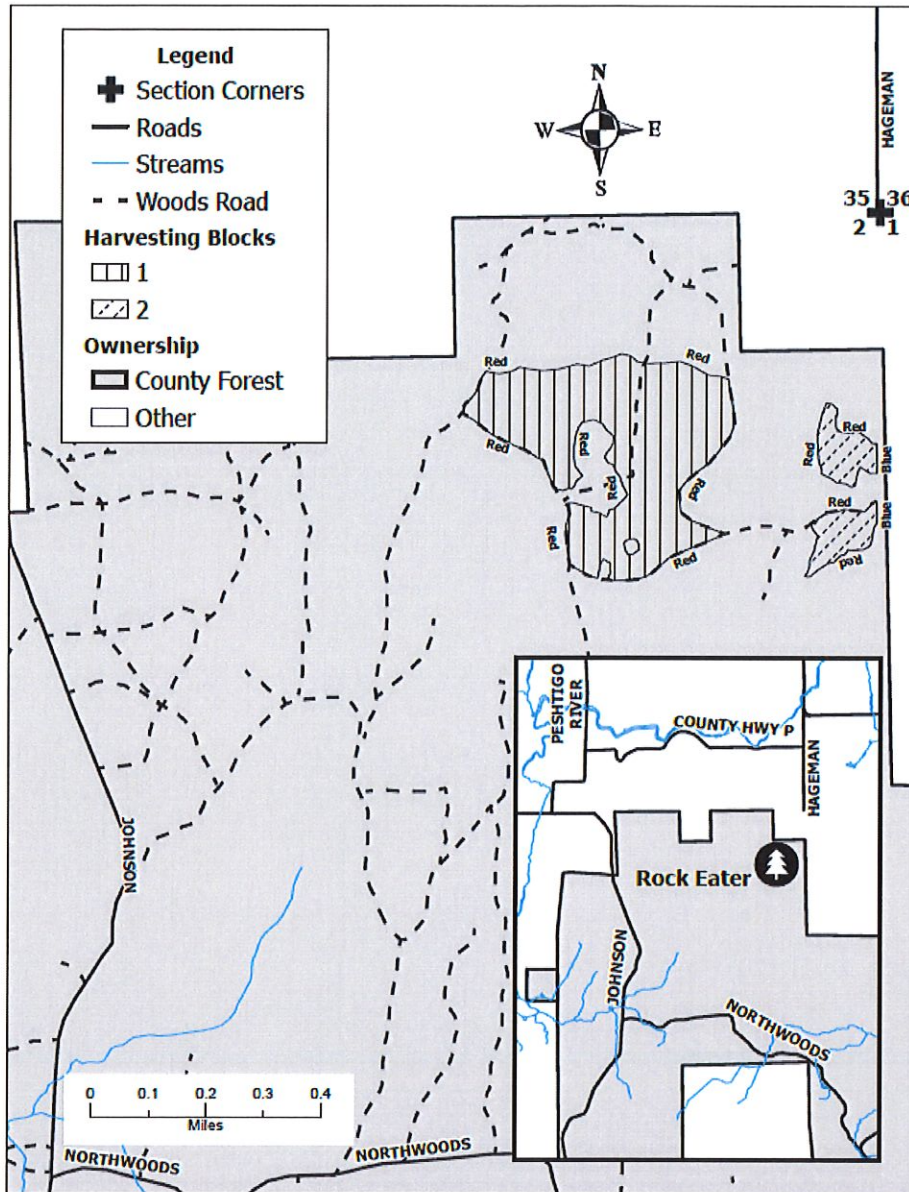

Harvest Specifications:

Block 1 – Northern Hardwood, 63 acres

- Cut all trees marked with orange paint. In addition, harvest all merchantable aspen, balsam fir, white birch and ironwood.

Block 2 – Aspen, 12 acres

- Cut all trees 2 inches and larger, EXCEPT red oak, yellow birch, cedar and trees marked with green paint.

All Blocks

- No cutting, skidding or trucking will be allowed during spring break up or wet soil conditions.
- No tree length or pole skidding is allowed without prior approval.
- All wood will be sorted by species and categories as listed in table below.
- All species and products shall be cut concurrently.
- Reasonable care shall be used to avoid unnecessary damage to reserve trees.
- **Do not cut dead trees unless marked with orange paint or, if they pose a safety hazard.**
- No equipment use or slash disposal in wetlands.
- Any gates, rocks, berms or other barriers removed for access will be repaired or replaced.
- All slash and logging debris must be lopped to within 2 feet of the ground and pulled back 25 feet from roads.

Sale Information:

- Pulp & Bolts - Mill Ticket
- Saw Logs – Field Scale
- Other Products – Determined by County
- Seasonal Restrictions:
 - Winter Only
- Completion Date: July 1, 2025
- Notify County in advance of starting
- Forestry Department: 715-478-3475

ESTIMATED VOLUME

Pulpwood / Bolts		Sawlogs	
Species	Tons (Cords)	Species	MBF
MIXED HARDWOOD	960 (400)	MIXED HARDWOOD	30
ASPEN	625 (280)	BASSWOOD	15
BASSWOOD	120 (60)	HARD MAPLE	4
BALSAM FIR	65 (30)		
Total	1770 (770)	Total	49

Forest County Forestry & Recreation Department

Timber Sale Bid Sheet

Advertised species, products and value for sale tract#: **3-22** Approximate cutting area: **75** acres
Township: **Lincoln**

Product Species	Estimated Unit Volume	Bid Per Unit	Total
20T-MX Mixed Hdwd Pulp	960.00 Tons		
20T-A Aspen Pulp	625.00 Tons		
20T-BA Bass Wood Pulp	120.00 Tons		
20T-FB Balsam Fir Pulp	65.00 Tons		
10-MX Mixed Hardwood Sawlogs	30.00 MBF		
10-BA Basswood Sawlogs	15.00 MBF		
10-MH Hard Maple Sawlogs	4.00 MBF		
	19,540.00		
	Minimum Total Bid		Total Bid

All products must have a bid price.

Bid bonds will be waived for 2022. If you are the successful bidder, you will be required to pay a performance bond of 25% of the total bid price at contract signing. You will also be required to provide copies of your SFI training and liability/workman's compensation certificates prior to signing the timber sale contract. At least one (1) person working on the sale must be SFI Certified. **Contracts will not be issued without the 25% performance bond, SFI training certificate and liability/workman's compensation certificate.**

NOTE: This bid, when properly filled out, should be placed in a plain envelope and sealed. Mark the envelope 'Sealed Bid - Timber Stumpage', indicate the Tract Number. Place this sealed envelope in a mailing envelope and mail to the Forest County Forestry & Recreation Department, 200 E. Madison St. Crandon, WI 54520. Bids may be hand delivered in a sealed envelope to the office. Check bid notice for deadline date and time. For more information, please call 715-478-3475. See timber Bid Conditions on the timber sale prospectus.

The Seller has the right to reject any and all bids. Volumes are estimates. All bidders are encouraged to examine sale to verify volumes and quality of all timber. Bidders should be prepared to submit a performance bond and references upon request.

Name _____

Address _____

City, State, Zip _____

Phone #: _____

Bidder Signature _____

Date _____

Forest County Forest
Hatchet Timber Sale – Tract 4-22
Parts of SENE, NESE, SWSE, SESE Sec. 11, SWNW, NWSW, SWSW Sec. 12, T.35N. R.13E.
Sale area 73 acres
(Mapped by Jared Oemig 2/28/2022)

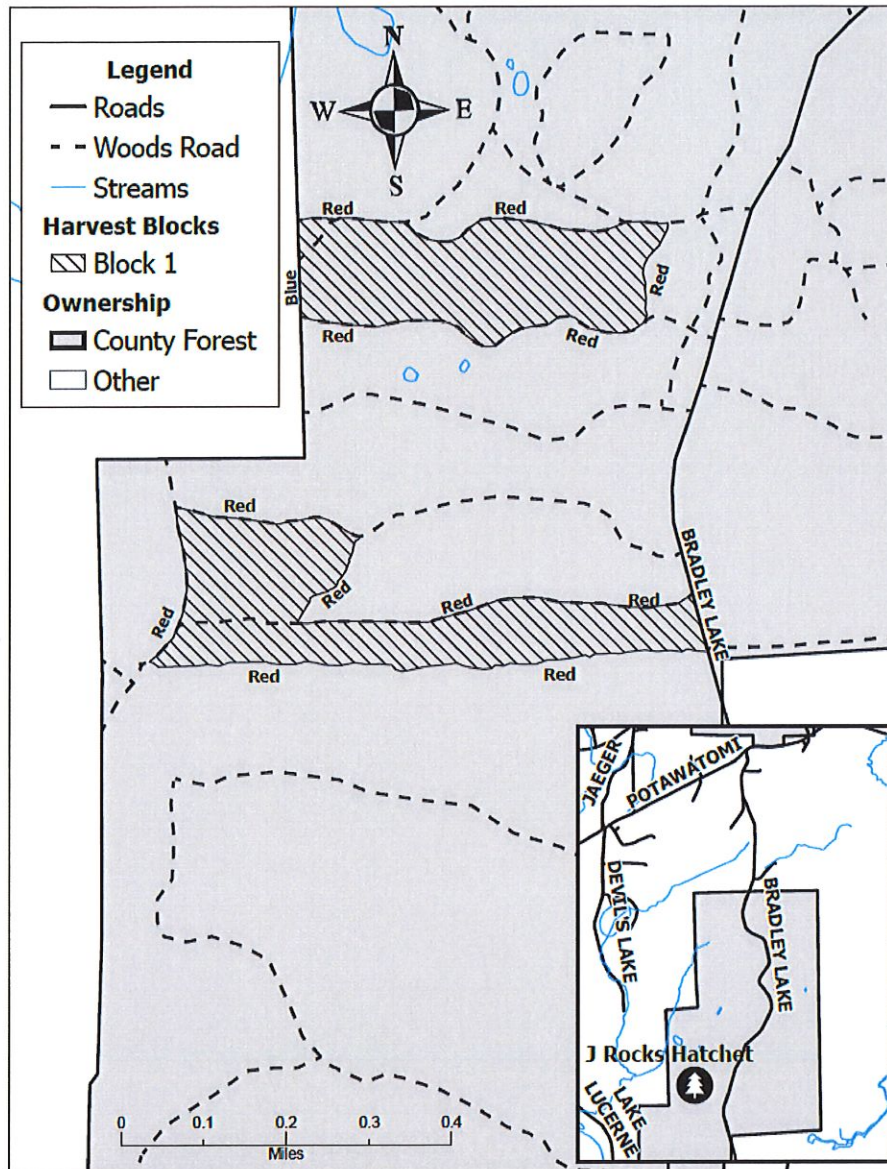

Harvest Specifications:

Block 1 – Aspen, 73 acres

- Cut all trees 2 inches and larger, **EXCEPT** red oak, yellow birch, and trees marked with green paint.

All Blocks

- No cutting, skidding or trucking will be allowed during spring break up or wet soil conditions.
- No tree length or pole skidding is allowed without prior approval.
- All wood will be sorted by species and categories as listed in table below.
- All species and products shall be cut concurrently.
- Reasonable care shall be used to avoid unnecessary damage to reserve trees.
- **Do not cut dead trees unless marked with orange paint or, if they pose a safety hazard.**
- No equipment use or slash disposal in wetlands.
- Any gates, rocks, berms or other barriers removed for access will be repaired or replaced.
- All slash and logging debris must be lopped to within 2 feet of the ground and pulled back 25 feet from road.

Sale Information:

- Pulp & Bolts - Mill Ticket
- Saw Logs – Field Scale
- Other Products – Determined by County
- Seasonal Restrictions:
 - March 15th - July 15th No Harvesting
- Completion Date: July 1, 2025
- Notify County in advance of starting
- Forestry Department: 715-478-3475

ESTIMATED VOLUME

Pulpwood / Bolts		Sawlogs	
Species	Tons (Cords)	Species	MBF
ASPEN	4600 (2050)	HARD MAPLE	2
MIXED HARDWOODS	480 (200)	MIXED HARDWOODS	2
BALSAM FIR	30 (15)		
Total	5110 (2265)	Total	4

Forest County Forestry & Recreation Department

Timber Sale Bid Sheet

Advertised species, products and value for sale tract#: **4-22** Approximate cutting area: **73** acres
 Township: **Lincoln**

Product Species		Estimated Unit Volume	Bid Per Unit	Total
20T-A	Aspen Pulp	4,600.00 Tons	_____	_____
20T-MX	Mixed Hdwd Pulp	480.00 Tons	_____	_____
20T-FB	Balsam Fir Pulp	30.00 Tons	_____	_____
10-MX	Mixed Hardwood Sawlogs	2.00 MBF	_____	_____
10-MH	Hard Maple Sawlogs	2.00 MBF	_____	_____
		42,987.00		
		Minimum Total Bid		Total Bid

All products must have a bid price.

Bid bonds will be waived for 2022. If you are the successful bidder, you will be required to pay a performance bond of 25% of the total bid price at contract signing. You will also be required to provide copies of your SFI training and liability/workman's compensation certificates prior to signing the timber sale contract. At least one (1) person working on the sale must be SFI Certified. **Contracts will not be issued without the 25% performance bond, SFI training certificate and liability/workman's compensation certificate.**

NOTE: This bid, when properly filled out, should be placed in a plain envelope and sealed. Mark the envelope 'Sealed Bid - Timber Stumpage', indicate the Tract Number. Place this sealed envelope in a mailing envelope and mail to the Forest County Forestry & Recreation Department, 200 E. Madison St. Crandon, WI 54520. Bids may be hand delivered in a sealed envelope to the office. Check bid notice for deadline date and time. For more information, please call 715-478-3475. See timber Bid Conditions on the timber sale prospectus.

The Seller has the right to reject any and all bids. Volumes are estimates. All bidders are encouraged to examine sale to verify volumes and quality of all timber. Bidders should be prepared to submit a performance bond and references upon request.

Name _____

Address _____

City, State, Zip _____

Phone #: _____

Bidder Signature _____

Date _____

Forest County Forest
Miss Bradley Timber Sale – Tract 5-22
NESW, NWSE, NESE, SWSE, SESE Sec. 12, T.35N. R.13E
Sale area 60 acres
(Mapped by Travis Wollenberg 4/13/22)

Harvest Specifications:

Block 1 – Aspen, 50 acres

- Cut all trees 2 inches and larger, **EXCEPT** red oak, yellow birch and trees marked with green paint

Block 2 – Red Pine, 10 acres

- Cut all trees marked with orange paint, with consideration for not damaging advanced regeneration.
- Fungicide treatment for Heterobasidion Root Disease must be applied to cut red pine stumps.

All Blocks

- No cutting, skidding or trucking will be allowed during spring break up or wet soil conditions.
- No tree length or pole skidding is allowed without prior approval.
- All wood will be sorted by species and categories as listed in table below.
- All species and products shall be cut concurrently.
- Reasonable care shall be used to avoid unnecessary damage to reserve trees.
- **Do not cut dead trees unless marked with orange paint or, if they pose a safety hazard.**
- No equipment use or slash disposal in wetlands.
- Any gates, rocks, berms or other barriers removed for access will be repaired or replaced.
- All slash and logging debris must be lopped to within 2 feet of the ground and pulled back 25 feet from roads.

Sale Information:

- Pulp & Bolts - Mill Ticket
- Saw Logs – Field Scale
- Other Products – Determined by County
- Seasonal Restrictions:
 - March 15 – July 15 No Harvesting
- Completion Date: July 1, 2025
- Notify County in advance of starting
- Forestry Department: 715-478-3475

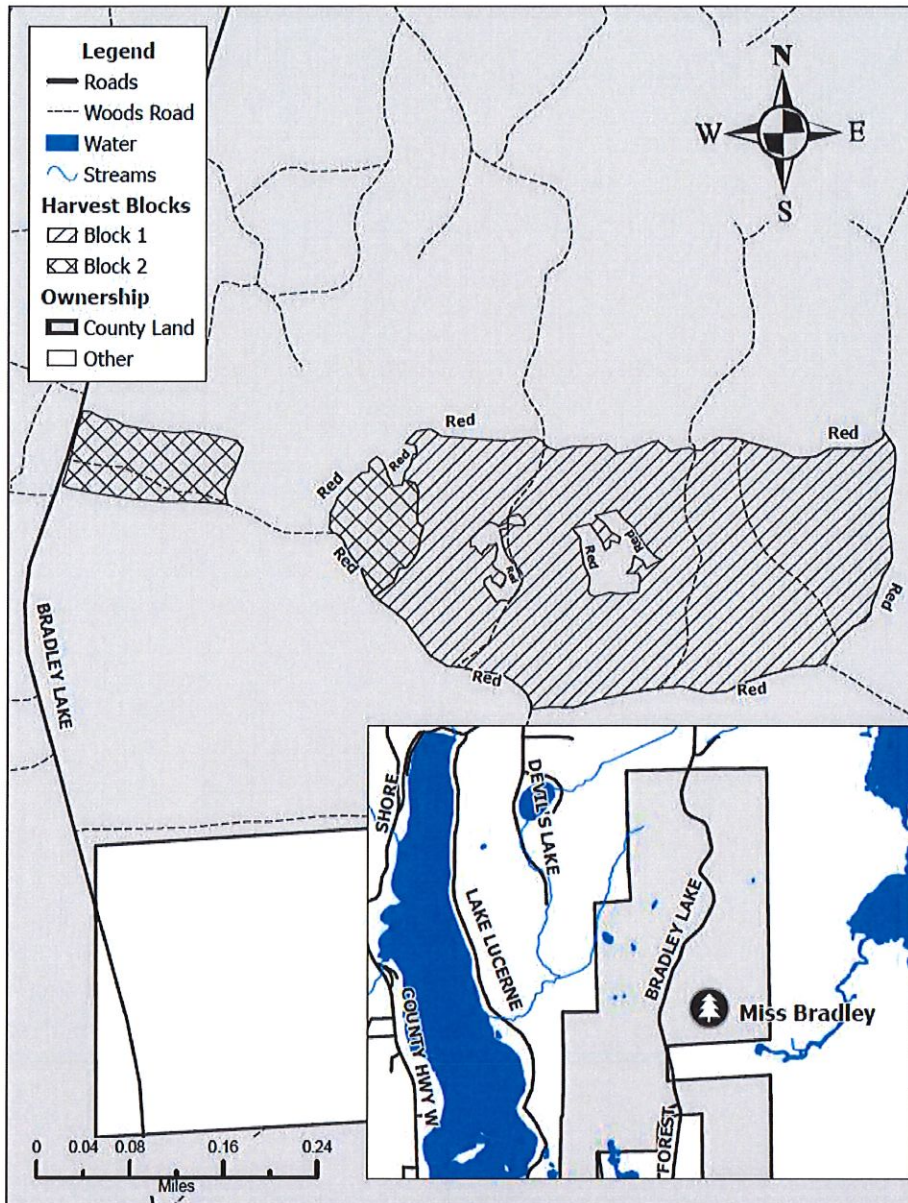

ESTIMATED VOLUME

Pulpwood / Bolts		Sawlogs	
Species	Tons (Cords)	Species	MBF
ASPEN	2,450 (1,100)	MIXED HARDWOODS	4
MIXED HARDWOODS	700 (300)	HARD MAPLE	2
RED PINE	200 (90)		
BALSAM FIR	25 (10)		
Total	2,275 (1,500)	Total	6

Forest County Forestry & Recreation Department

Timber Sale Bid Sheet

Advertised species, products and value for sale tract#: **5-22** Approximate cutting area: **60** acres
 Township: **Lincoln**

Product Species		Estimated Unit Volume	Bid Per Unit	Total
20T-A	Aspen Pulp	2,450.00 Tons	_____	_____
20T-MX	Mixed Hdwd Pulp	700.00 Tons	_____	_____
18T-PR	Comingled Red Pine	200.00 Tons	_____	_____
20T-FB	Balsam Fir Pulp	25.00 Tons	_____	_____
10-MX	Mixed Hardwood Sawlogs	4.00 MBF	_____	_____
10-MH	Hard Maple Sawlogs	2.00 MBF	_____	_____
		29,682.50		
Minimum Total Bid				Total Bid

All products must have a bid price.

Bid bonds will be waived for 2022. If you are the successful bidder, you will be required to pay a performance bond of 25% of the total bid price at contract signing. You will also be required to provide copies of your SFI training and liability/workman's compensation certificates prior to signing the timber sale contract. At least one (1) person working on the sale must be SFI Certified. **Contracts will not be issued without the 25% performance bond, SFI training certificate and liability/workman's compensation certificate.**

NOTE: This bid, when properly filled out, should be placed in a plain envelope and sealed. Mark the envelope 'Sealed Bid - Timber Stumpage', indicate the Tract Number. Place this sealed envelope in a mailing envelope and mail to the Forest County Forestry & Recreation Department, 200 E. Madison St. Crandon, WI 54520. Bids may be hand delivered in a sealed envelope to the office. Check bid notice for deadline date and time. For more information, please call 715-478-3475. See timber Bid Conditions on the timber sale prospectus.

The Seller has the right to reject any and all bids. Volumes are estimates. All bidders are encouraged to examine sale to verify volumes and quality of all timber. Bidders should be prepared to submit a performance bond and references upon request.

Name _____

Address _____

City, State, Zip _____

Phone #: _____

Bidder Signature _____

Date _____